

Illustrations: Distributed creativity: collaborative digital textile design practice

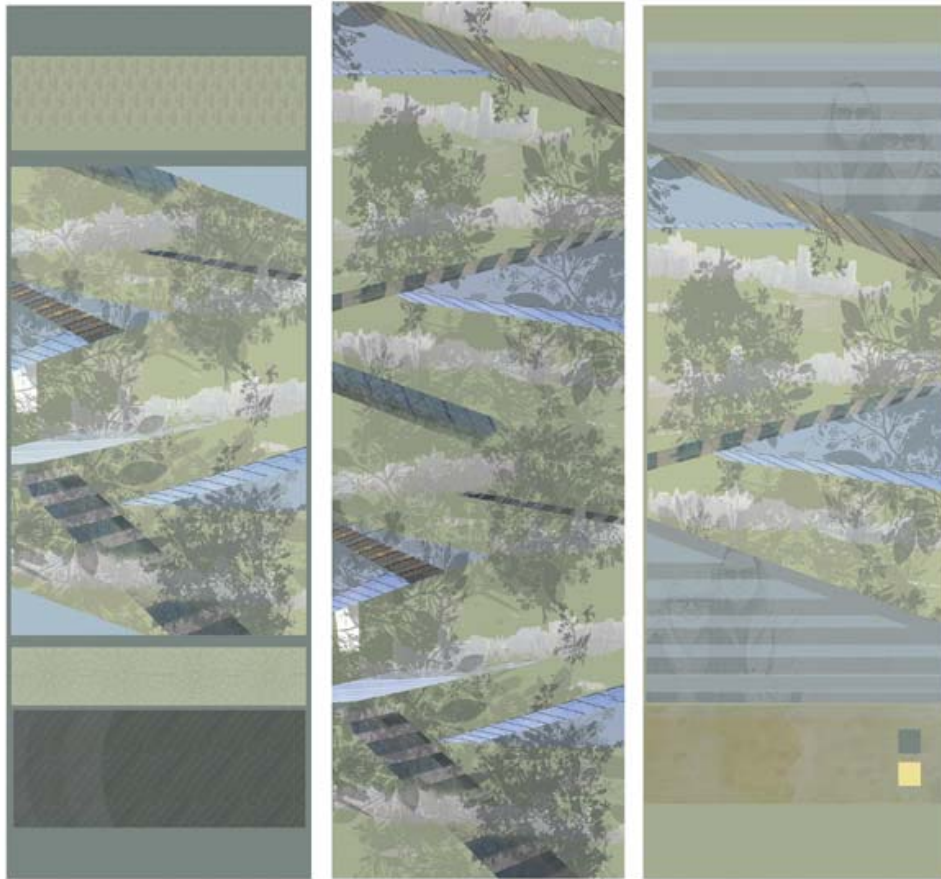

Fig.1 New York Skyline and detail (below)
Digital print on cotton velvet

3 Panels size: 200cm x 50cm

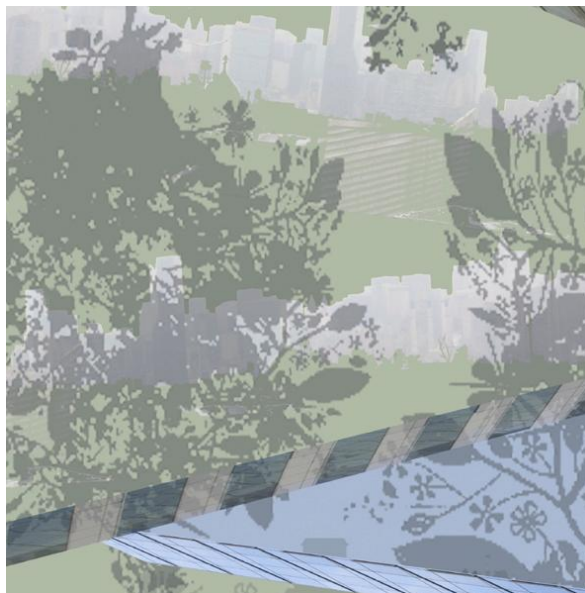

Fig. 2 Empire State
Digital print on cotton velvet
Size: 200cmx 50cm

Fig. 3 Wales Design Collection



1. Poppies and church window

Developed from a digital photograph of a stained glass window and Welsh poppies.



2. Viola and organ pipes

This concept led to the development of 3. *Viola with dark background* in which the scale of some of the flowers have been digitally enlarged, the background re-coloured and the blue and yellow flowers incorporated from 4. *Grass*.

The concept developed from a photograph of church organ pipes combined with scanned flowers.



3. Viola dark background

4. Grass



5. Thistles

Developed from the grass design with cornflowers and thistles.



All the concepts depicted are digital repeat units and can be digitally ink-jet printed at any size.

Test prints were made on a variety of apparel fabrics including cotton lawn, silk crepe de chine and silk chiffon.

The detail obtained on the silk crepe de chine was particularly notable and since the files are high resolution (300 dpi) can be printed to the full width of fabric 140cms without obvious pixilation.

6. Poppies and cornflowers

This final concept combines elements from all the others, linking colours and shapes in the collection.



Fig. 4

Poppy and organ pipes

Digital print on silk crepe de chine

Photo © CT



Fig. 5

Viola with dark background

Digital print on silk crepe de chine

Photo ©CT